

OmniAccess 6000 200W Power Supply Unit

Installation Instructions

The 200W Power Supply Unit (Part Number OAW-6000-PS200) is a field replaceable, hot-swappable component for the OmniAccess 6000 series Wireless LAN Switches. Before installing the 200W PSU, make sure you understand this procedure and all precautions.

NOTE—The 200W PSU does not support Power over Ethernet or Serial Power over Ethernet (POE or SPOE). If SPOE or POE are required, use the 400W Power Supply Unit (OAW-6000-PS400).

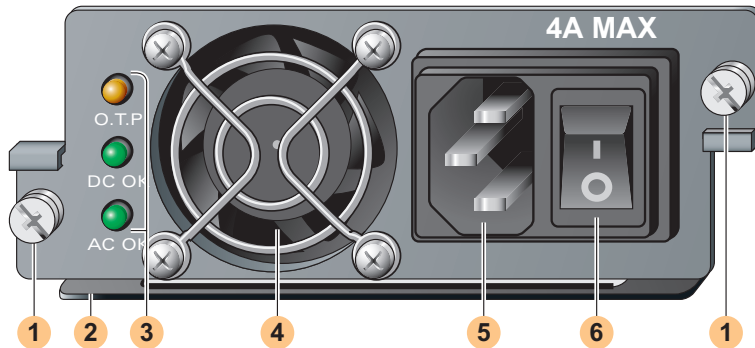

NOTE—The components are:

1. Captive screws (2)
2. Unit handle used to insert or remove the power supply



CAUTION—Do not use the handle to lift the Alcatel Wireless LAN Switch.

3. LEDs
When installed correctly, the bottom LED (AC OK) and middle LED (DC OK) should be green. The top LED (OTP - Over Temperature Protection - should be off). For more information on the LEDs refer to the installation guide.
4. Fan intake vent
5. Power connector
6. Power On/Off Switch - Off (O) and On (I)

To Install the 200W PSU



CAUTION—Be sure to exercise proper Electrostatic Discharge (ESD) precautions when handling components.

1. **Select a power supply slot for the power supply.**

Individual 200W power supply can be installed in any power supply slots. However, a maximum of two **200W power supply** units can be installed, and when two power supplies are installed, they must be installed as shown below (in slots 0 and slot 2).

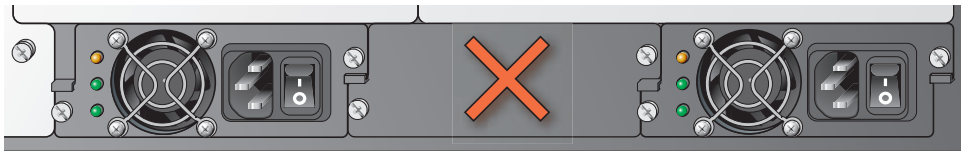

CAUTION—Do not mix 200W and 400W power supplies in the same chassis. This will not cause physical damage, but mixing power supplies will cause the switch to read a 400W PSU as a 200W PSU. Since 200W PSUs do not support SPOE, SPOE support is disabled when the switch detects a 200W PSU installed.

If you are replacing a previously installed power supply, turn it off, and unplug it. Use a #2 Phillips or cross-head screwdriver to turn the power supply's captive fastening screws counter-clockwise until they are loose (they cannot be completely removed). Firmly grasp the handle of the power supply and carefully pull the module out of the switch's power supply slot.

If you are installing a power supply in an empty slot, you may have to remove the blank cover plate first. To do this, use a #2 Phillips or cross-head screwdriver. Turn the captive fastening screws on the faceplate counter-clockwise until they are loose (they cannot be completely removed). Remove the cover plate and store it in a safe place.

2. **Make sure the power switch on the power supply to be installed is Off (O).**



CAUTION—Never insert or remove a power supply while its power switch is in the On (I) position. Make sure the power switch is Off (O) first.

3. **Insert the power supply into the chassis.**

Grasp the power supply by handle, keeping the LEDs on the left and power switch on the right. Align the back of the module with the guide-rails in the chassis power supply slot and gently slide in the module. Do not force the module; it should slide in easily most of the way. There may be moderate resistance when the power supply meets the connectors at the back of the chassis. Press firmly to engage the connectors, but do not use excessive force.

4. **Secure the power supply.**

Use the screwdriver to push in the module's captive fastening screws and turn them clockwise until moderate resistance is felt. Do not over-tighten.

5. **Attach the power cord to the power supply.**

Plug an appropriate power cord into the power input socket. The socket accepts a power cord with a standard IEC320 plug



CAUTION—For proper safety and performance, the power cord must be rated to 10 A and conform to grounded electrical standards in the country where the product is operated.

6. **Attach the power cord to a proper electrical outlet.**

Make sure that your site's electrical systems can handle the switch's power load.

Each standard power supply is rated at 200 W total and is auto-ranging to accept 90-132/ 170-264 VAC, at 50 to 60 Hz.

Depending on the switch's total power load, you may be required to increase the capacity of your site's electrical systems. Refer to the installation guide for information on maximum power load.

26801 West Agoura Road
Calabasas, California 91301 USA

Contact Center
(800) 995-2612 US/Canada
(818) 880-3500 Outside US
www.alcatel.com/enterprise

